

**TO LET**

**2ND FLOOR, ULSTER BANK BUILDING, DA VINCI COMPLEX, CULMORE ROAD,  
DERRY~LONDONDERRY, BT48 8JB**

MODERN OFFICE SUITE OF C. 3,613 SQ. FT. WITH ON-SITE CAR PARKING.

**Lisney**

COMMERCIAL REAL ESTATE



OUTLINE FOR INDICATIVE PURPOSES ONLY

**Lisney**

COMMERCIAL REAL ESTATE

## FEATURES

Excellent office suite within a landmark building

Highly prominent location fronting Culmore Road, one of the city's arterial routes

Fitted to a high specification with exceptional natural lighting

Air conditioned

On site parking with 5 allocated spaces

Excellent local amenities

## LOCATION

The subject property is situated in Derry~Londonderry, the second largest city in Northern Ireland with a population of circa 111,000. It is approximately 71 miles north west of Belfast and 130 miles north west of Dublin.

Due to the location of Derry – Londonderry in the north west and the close proximity to the border with the Republic of Ireland, the City acts as the principal retail and administrative centre for the City Council area and neighbouring areas such as Strabane, Limavady and parts of Donegal.

The Ulster Bank Building fronts the Culmore Road, one of the principle arterial routes into the City, with an estimated 20,000 cars passing the site daily.

The property benefits from strong road links throughout the province, along with being just 3 miles from Foyle Port and 8 miles from City of Derry Airport.

## DESCRIPTION

The subject suite is located on the 2nd floor of the Ulster Bank Building, a prominent and modern 4-storey retail and office property on the Culmore Road.

The building is extremely prominent and has a corporate, headquarter presence. The suite is accessed from the front of the building, through a modern common atrium with lift access. Internally, the suite comprises open plan work space with a large board room, kitchen/staff room, WC's and stores.

It is finished to a high standard to include air conditioning, suspended ceilings with recessed LED lighting, plastered and painted walls and raised access carpeted floors. With windows on all aspects, the space provides excellent natural lighting and views across the city.

The building benefits from on site car parking facilities and access to a private car park at Da Vinci's Hotel which is adjacent to the Building.

5 dedicated parking spaces are offered with the suite.





## INDICATIVE FLOOR PLAN

### ACCOMMODATION

Approximately 3,613 Sq. Ft.

### RENT

c. £12.50 psf per annum.

### TERMS

Negotiable.

### SERVICE CHARGE

A service charge will be levied to cover an appropriate proportion of the cost of exterior repairs, maintenance and management of the building and this will also include general upkeep of the complex.

### REPAIRS/INSURANCE

Effective FRI lease by way of service charge liability.

### BUILDINGS INSURANCE

The tenant is to reimburse the landlord in respect of a fair proportion of the building's insurance premium.

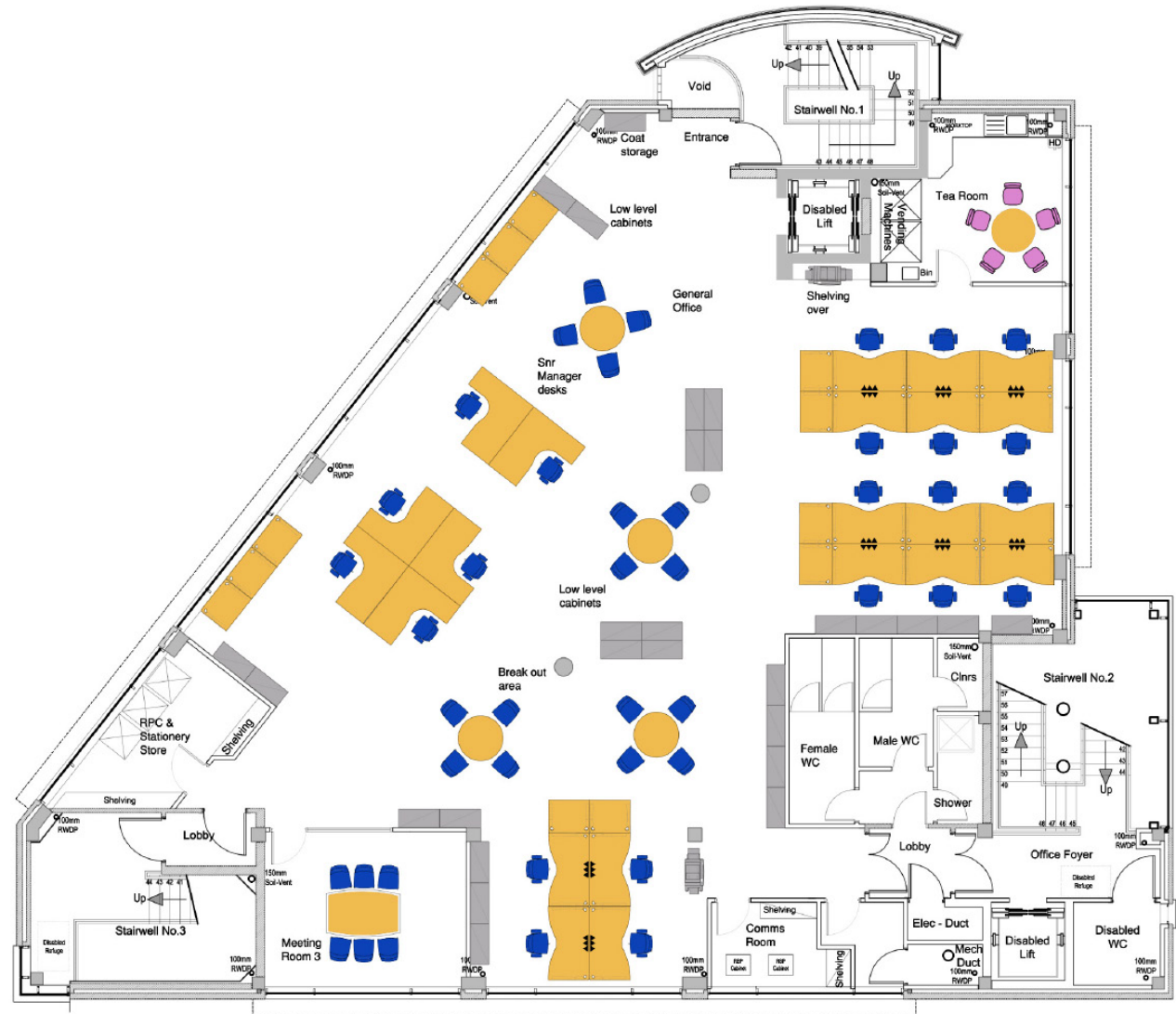



## EPC

The property has an Energy Efficiency rating of B40. The full Certificate can be made available upon request.

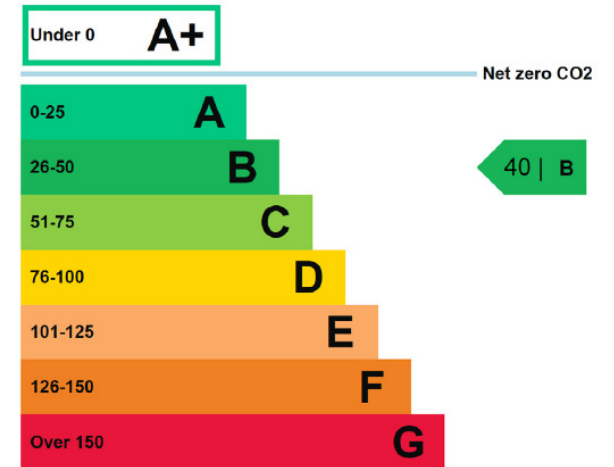

## RATES PAYABLE

We understand the following applies:

Net annual value	£36,700
Rate in the £24/25	£0.667608
Payable 2024/25	£24,501

## VALUE ADDED TAX

All prices, outgoings and rentals are exclusive of, but may be liable to VAT.



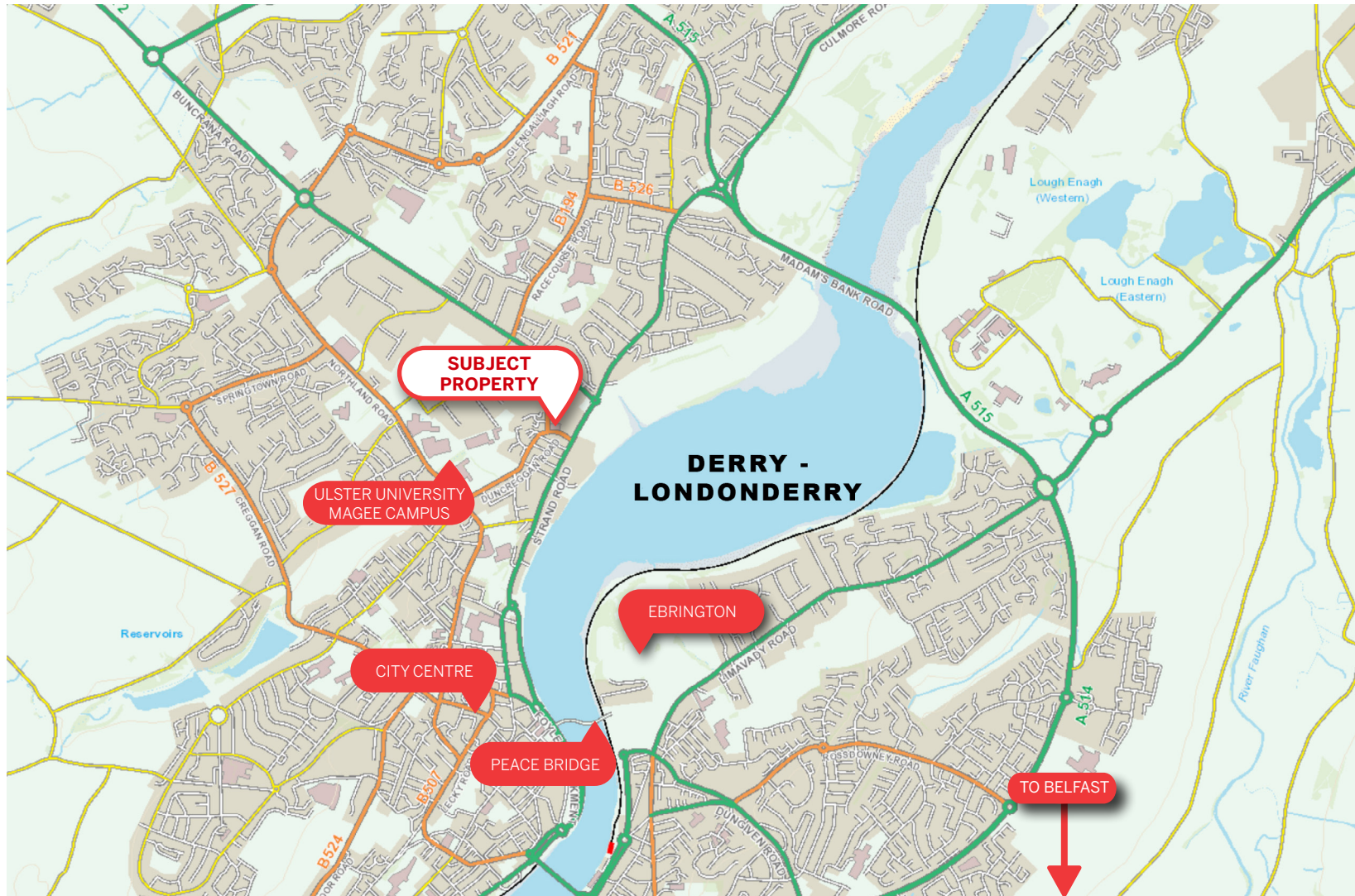

**Lisney**  
COMMERCIAL REAL ESTATE

**For further information:**

**Lynn Taylor: 028 9050 1556 / 07813 020 181**

**[ltaylor@lisney-belfast.com](mailto:ltaylor@lisney-belfast.com)**

Viewing Strictly by appointment with the sole selling agent Lisney.

**Lisney Commercial Real Estate**

**3rd Floor, Montgomery House,  
29-33 Montgomery St., Belfast, BT1 4NX  
Tel: 028 90 501 501**

**Email: [property@lisney-belfast.com](mailto:property@lisney-belfast.com)**

**lisney.com**   

The Directors of Lisney for themselves and for the vendors or lessors of this property whose agents they are give notice that (i) the particulars are set out as a general outline only for the guidance of intended purchasers or lessors, and do not constitute part of, an offer or contract; (ii) all descriptions, references to condition and necessary permissions for use and occupation, and other details are given without responsibility and any intending purchasers or tenants should not rely on them as statements or representations of fact but must satisfy themselves by inspection or otherwise as to the correctness of each of them; (iii) no person in the employment of the Directors of Lisney has any authority to make or give any representation or warranty whatever in relation to the property.

