



31 Carysfort Downs
Blackrock, Co. Dublin

Lisney | Sotheby's
INTERNATIONAL REALTY



31 Carysfort Downs, Blackrock, Co. Dublin

Features

- Impressive detached, double fronted family residence.
- Secluded, south facing rear garden.
- Cleverly extended with a perfect balance of reception rooms and bedrooms.
- Good decorative order throughout.
- Five generous bedrooms.
- Peaceful cul-de-sac setting in this popular residential area.
- Ample off street car parking.
- Gas fired central heating.
- Double glazed windows throughout.
- Generous, well laid out accommodation extending to approximately 156sqm (1,679sqft).

A tastefully refurbished, double fronted detached family home, originally built by Charles Church, superbly located in this mature development off Carysfort Avenue, within walking distance of Blackrock & Stillorgan Villages. This property has been cleverly extended and boasts a delightful private South facing garden.

The generous family accommodation includes on the ground floor; a welcoming reception hall with w.c off, large living room with bay window and feature fireplace open to the dining room and through to the sunroom with doors to the rear garden. There is a large kitchen / breakfast room with door to a separate utility and a cosy study/ playroom to the front. On the first floor there are five well sized bedrooms (main with ensuite) and a family bathroom.

To the front, there is a landscaped, hedged, low maintenance garden, with ample off street car parking. There is also a pedestrian gate to the side. The sun trap rear garden has a sunny, south facing aspect with landscaped low maintenance garden with patio area and mature plants and shrubs.

Number 31 Carysfort Downs is tucked away to the rear of Carysfort Downs in a quiet cul-de-sac off Carysfort Avenue enjoying a lovely leafy outlook, a deservedly popular residential location, a short distance to the shops at Frascati, Blackrock, & Stillorgan shopping centres. The QBC on the Stillorgan Road together with Blackrock DART station allow for ease of access to Dublin city centre. The M50 is within easy reach affording easy access to all points north, south, east, and west. A wide selection of fine primary and secondary schools are close to hand to include: Carysfort N.S., All Saint's N.S., St Andrew's College, Blackrock College, Loreto Foxrock and Mount Anville. Also close to hand are a good choice of restaurants and amenities in Blackrock Village.







Accommodation

Hallway: 3.97m x 2.2m (13' x 7'3")

WC: part tiled walls, tiled floor, whb, wc

Cloakroom: with alarm panel

Play Room / Study: 2.2m x 4.6m (7'3" x 15'1") with bay window, cast iron fireplace, wood burning stove, solid wood flooring, recessed lighting

Living Room: 3.8m x 5.8m (12'6" x 19') with solid wood flooring, attractive bay window overlooking front, stone mantelpiece with gas fire inset, open to

Dining Room: 2.98m x 3.28m (9'9" x 10'9") with solid wood flooring and door to kitchen, open to

Sun Room: 3.4m x 3m (11'2" x 9'10") with solid wood flooring, recessed lighting, door to rear garden

Kitchen/Breakfast Room: 5.6m x 4.2m (18'4" x 13'9") with tiled floors, extensive range of wall and floor units, integrated fridge/freezer, extractor fan, space for cooker, dishwasher, stainless steel sink, breakfast bar, space for dining table and chairs with sliding doors into

Utility Room: 1.46m x 2.24m (4'9" x 7'4") with wall and floor units, stainless steel sink, plumbed for washing machine and dryer and houses the gas boiler

Landing: with access to attic, shelved hotpress

Family Shower Room: with tiled walls and tiled floor, wc, recessed lighting, step in shower with rainfall shower head

Bedroom 1: 4m x 3.39m (13'1" x 11'1") with built in wardrobes, situated to the front

Ensuite Bathroom: with tiled walls, tiled floors, whb, wc, recessed lighting, step in shower, extractor fan

Bedroom 2: 3.35m x 3.3m (11' x 10'10") with solid wood flooring

situated to the rear

Bedroom 3: 5.2m x 2.6m (17'1" x 8'6") with built in wardrobes and solid wood flooring overlooking the rear

Bedroom 4: 2.2m x 3.6m (7'3" x 11'10") overlooking the front with solid wood flooring

Bedroom 5: 2.9m x 2.67m Overlooking the front with storage cupboard

BER Information

BER: C2. BER No: 100220102.

EPI: 2196.46 kWh/m²/yr.

Eircode

A94 N7E5





OFFICES

51 Mount Merrion Avenue,
Blackrock, Co. Dublin,
A94 W6K7.
T: 01 280 6820
E: blackrock@lisneysir.com

8 Railway Road, Dalkey,
Co. Dublin, A96 D3K2.
T: 01 285 1005

103 Upper Leeson Street,
Ballsbridge, Dublin 4,
D04 TN84.
T: 01 662 4511

29 Dunville Avenue,
Ranelagh, Dublin 6,
D06 K283.
T: 01 662 4511

St. Stephen's Green House,
Earlsfort Terrace, Dublin 2,
D02 PH42
T: 01 638 2700

55 South Mall,
Cork, T12 RR44
T: 021 427 8500



lisneysir.com

First Floor

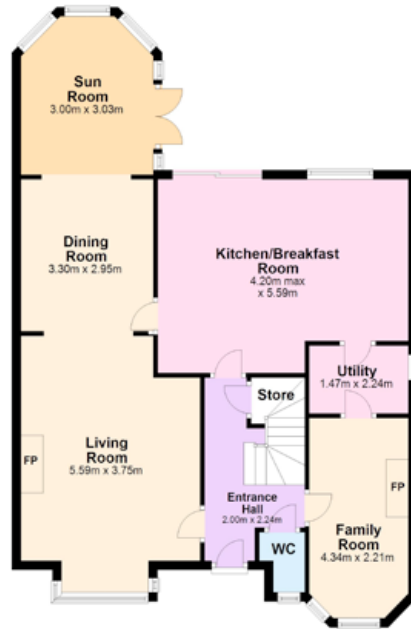

First Floor

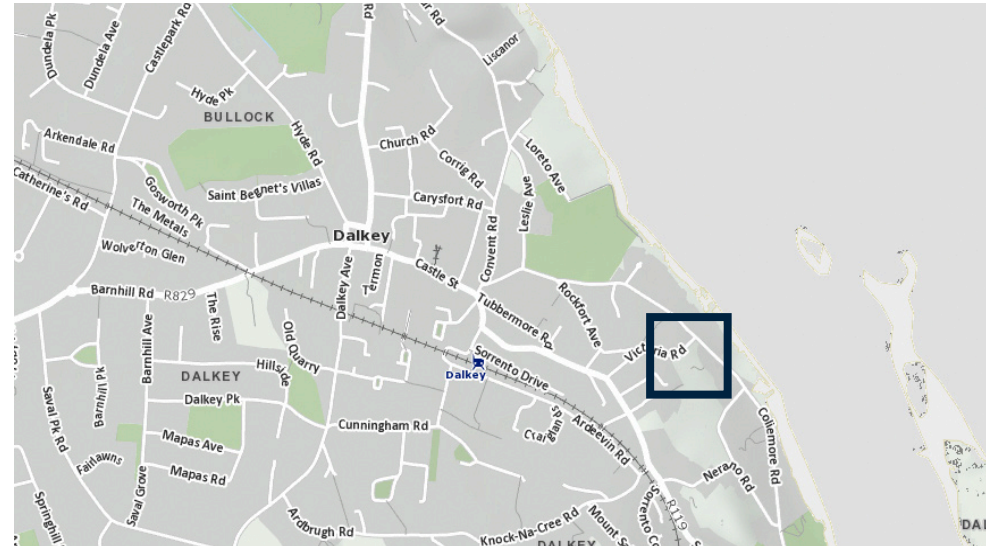
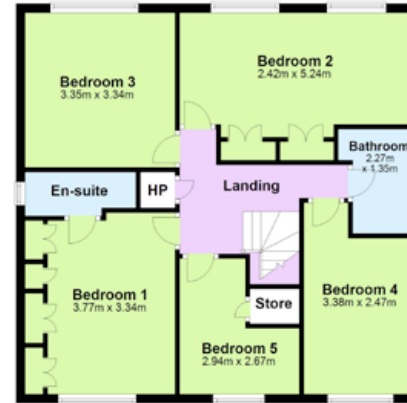

Copyright © Talte Eirreann - Surveying
Licence No. CYAL50423539

Lisney Sotheby's International Realty is an Independently Owned and Operated Company.

Any intending purchaser(s) shall accept that no statement, description or measurement contained in any newspaper, brochure, magazine, advertisement, handout, website or any other document or publication, published by the vendor or by Lisney Sotheby's International Realty, as the vendor's agent, in respect of the premises shall constitute a representation inducing the purchaser(s) to enter into any contract for sale, or any warranty forming part of any such contract for sale. Any such statement, description or measurement, whether in writing or in oral form, given by the vendor, or by Lisney Sotheby's International Realty as the vendor's agent, are for illustration purposes only and are not to be taken as matters of fact and do not form part of any contract. Any intending purchaser(s) shall satisfy themselves by inspection, survey or otherwise as to the correctness of same. No omission, misstatement, misdescription, incorrect measurement or error of any description, whether given orally or in any written form by the vendor or by Lisney Sotheby's International Realty as the vendor's agent, shall give rise to any claim for compensation against the vendor or against Lisney Sotheby's International Realty, nor any right whatsoever of rescission or otherwise of the proposed contract for sale. Any intending purchaser(s) are deemed to fully satisfy themselves in relation to all such matters. These materials are issued on the strict understanding that all negotiations will be conducted through Lisney Sotheby's International Realty. Please note we have not tested any apparatus, fixtures, fittings, or services. Interested parties must undertake their own investigation into the working order of these items. All measurements are approximate and photographs provided for guidance only. PSRA No. 001848.





© 2022 Sotheby's International Realty. All Rights Reserved. Sotheby's International Realty® is a registered trademark and used with permission. Each Sotheby's International Realty office is independently owned and operated, except those operated by Sotheby's International Realty, Inc. This material is based upon information which we consider reliable but because it has been supplied by third parties, we cannot represent that it is accurate or complete and it should not be relied upon as such. All offerings are subject to errors, omissions, changes including price or withdrawal without notice. If your property is listed with a real estate broker, please disregard. It is not our intention to solicit the offerings of other real estate brokers. We are happy to work with them and cooperate fully. Equal Housing Opportunity.

Lisney | Sotheby's
INTERNATIONAL REALTY