



11 Arundel

Monkstown Valley, Monkstown, Co. Dublin

Lisney | Sotheby's  
INTERNATIONAL REALTY



## 11 Arundel, Monkstown Valley, Monkstown, Co. Dublin

### Features

- Short walk to the DART and swimming at Seapoint
- Off street parking
- Close to both Monkstown and Blackrock
- Floor area of approximately 87 sq.m. (936 sq.ft.).
- Electric storage heating
- Service charge approximately €650 per annum Landscaped grounds maintained to an excellent standard
- Off street parking

11 Arundel is well located within this highly sought-after development, just a short stroll from Seapoint and Monkstown Village. The property benefits from off street parking to the front and a private and secluded garden to the rear with side access.

Briefly the accommodation comprises an entrance hallway which leads to a large living room with open fireplace and window overlooking the front. To the rear there is a well fitted kitchen/ breakfast room with patio doors leading to the rear garden. Upstairs, there are 3 bedrooms (main en suite) and a bathroom.

Monkstown Valley is a highly convenient location only a few minutes' walk from the bustling village of Monkstown with its wide selection of local and boutique shops, cafes, pubs and some of the finest restaurants in South County Dublin. There is more extensive shopping available in Blackrock, just a short commute away. Primary and secondary schools are in abundance. There are also many recreational and leisure activities and sporting venues such as rugby, hockey and tennis with Monkstown and Blackrock (Green Road) Tennis Clubs only a short drive away. The four yacht clubs and extensive marina at DunLaoghaire Harbour, along with its two piers will be of major interest to walkers, and marine and sailing enthusiasts. Easy access to the new coastal cycle route toward either Dun Laoghaire or Howth provides ample opportunity for scenic cycles. Being within minutes' walk of the seafront there are also lovely tranquil walks in the immediate area and the ease of a sea dip at Seapoint. This is a highly desirable and convenient location that is perfect for easy family living. A regular bus service and both Salthill/Monkstown and Seapoint DART stations only a few minutes' walk away, make commuting to schools and the city centre exceptionally easy.



## Accommodation

**Reception Hall:** 1.2m x 4.3m (3'11" x 14'1") leads to

**Living Room:** 3.5m x 6m (11'6" x 19'8") with raised open fire place, tiled hearth and bay window overlooking front

**Kitchen/Breakfast Room:** 2.9m x 4.8m (9'6" x 15'9") breakfast area with tiled floor, patio door leading to rear garden, kitchen is fitted with a range of overhead press and drawer units, stainless steel oven with four ring ceramic hob and extractor over, stainless steel sink unit, dishwasher, washing machine, window overlooking rear, tiled floor and tiled splashback

**Bedroom 1:** 2.9m x 4.3m (9'6" x 14'1") with window overlooking

rear, floor to ceiling built in fitted wardrobes and door to

**Ensuite:** comprising pedestal whb, wc, corner shower and part tiled walls

**Bedroom 2:** 2m x 3.6m (6'7" x 11'10") with floor to ceiling built in fitted wardrobes

**Bedroom 3:** 2.85m x 3.3m (9'4" x 10'10") with floor to ceiling built in fitted wardrobes and window to front

**Bathroom:** comprising pedestal wash hand basin, wc, bath with telephone shower, bidet, hot press, tiled floor, part tiled walls, window to side and access to attic

## BER Information

BER: D1

## Eircode

A94 W6W2



## OFFICES

51 Mount Merrion Avenue,  
Blackrock, Co. Dublin,  
A94 W6K7.  
T: 01 280 6820  
E: blackrock@lisneysir.com

8 Railway Road,  
Dalkey, Co. Dublin,  
A96 D3K2.  
T: 01 285 1005

103 Upper Leeson Street,  
Ballsbridge, Dublin 4,  
D04 TN84.  
T: 01 662 4511

St. Stephen's Green House,  
Earlsfort Terrace, Dublin 2,  
D02 PH42.  
T: 01 638 2700

29 Dunville Avenue,  
Ranelagh, Dublin 6,  
D06 K283.  
T: 01 662 4511

1 South Mall,  
Cork, T12 CCN3  
T: 021 427 8500



lisneysir.com

FLOOR PLANS Not to scale - for identification purpose only.

Ground Floor

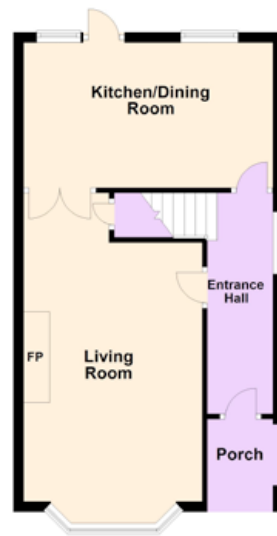

First Floor

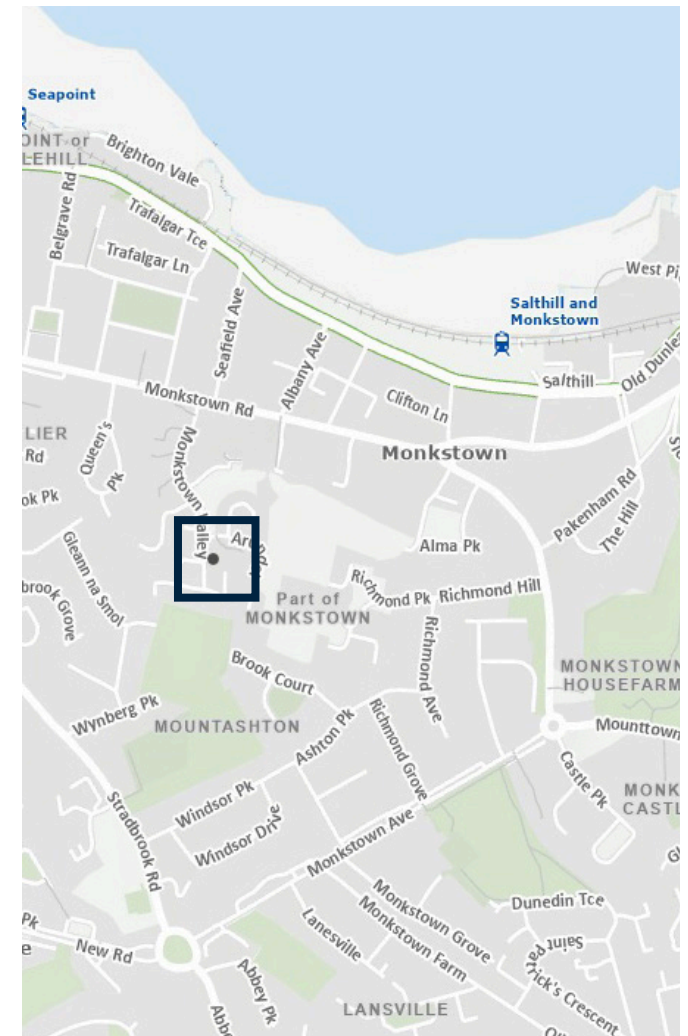
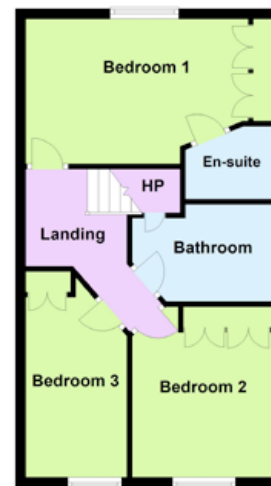

Copyright © Talis Eireann - Surveying  
Licence No. CTA/LS0423539.

Lisney Sotheby's International Realty is an Independently Owned and Operated Company.

Any intending purchaser(s) shall accept that no statement, description or measurement contained in any newspaper, brochure, magazine, advertisement, handout, website or any other document or publication, published by the vendor or by Lisney Sotheby's International Realty, as the vendor's agent, in respect of the premises shall constitute a representation inducing the purchaser(s) to enter into any contract for sale, or any warranty forming part of any such contract for sale. Any such statement, description or measurement, whether in writing or in oral form, given by the vendor, or by Lisney Sotheby's International Realty as the vendor's agent, are for illustration purposes only and are not to be taken as matters of fact and do not form part of any contract. Any intending purchaser(s) shall satisfy themselves by inspection, survey or otherwise as to the correctness of same. No omission, misstatement, misdescription, incorrect measurement or error of any description, whether given orally or in any written form by the vendor or by Lisney Sotheby's International Realty as the vendor's agent, shall give rise to any claim for compensation against the vendor or against Lisney Sotheby's International Realty, nor any right whatsoever of rescission or otherwise of the proposed contract for sale. Any intending purchaser(s) are deemed to fully satisfy themselves in relation to all such matters. These materials are issued on the strict understanding that all negotiations will be conducted through Lisney Sotheby's International Realty. Please note we have not tested any apparatus, fixtures, fittings, or services. Interested parties must undertake their own investigation into the working order of these items. All measurements are approximate and photographs provided for guidance only. PSRA No. 001848.